



FIRESTOP CENTRE

Authorised New Zealand Distributor
Ph (09) 483 4000 www.firestopcentre.co.nz

INSTALLATION INSTRUCTIONS

Rectangular aperture with annular gap but no greater than 30mm at the four contact points.

7k-ou\h y

u Attach 0.8mm thick slotted steel angle 75mm x 75mm bent around the duct on all sides.

Fix to the duct with steel rivets 10mm x 5mm diam at 100mm centres.

Fix to the floor with masonry screws (min 40mm) at the four contact points with a minimum of 3 fixings per side.

On side construct a collar from 60mm Protecta FR Board to cover the opening from the duct to the floor. Overlap the concrete 80mm. Fix to the floor with 8-10g x 75mm screws with penny washers at 200mm centres.

Apply sealant to fill any gaps in the collar. Then apply a 20mm fillet at the floor/collar joint and the duct/collar/angle joint. Finally cover the exposed cut edges of the collar with sealant or Protecta FR Coating.

Install the Firestop Duct Wrap as specified and apply sealant to the wrap/collar junction.

NOTE: Diagram shows 2 layer system, but see details on right for number of layers

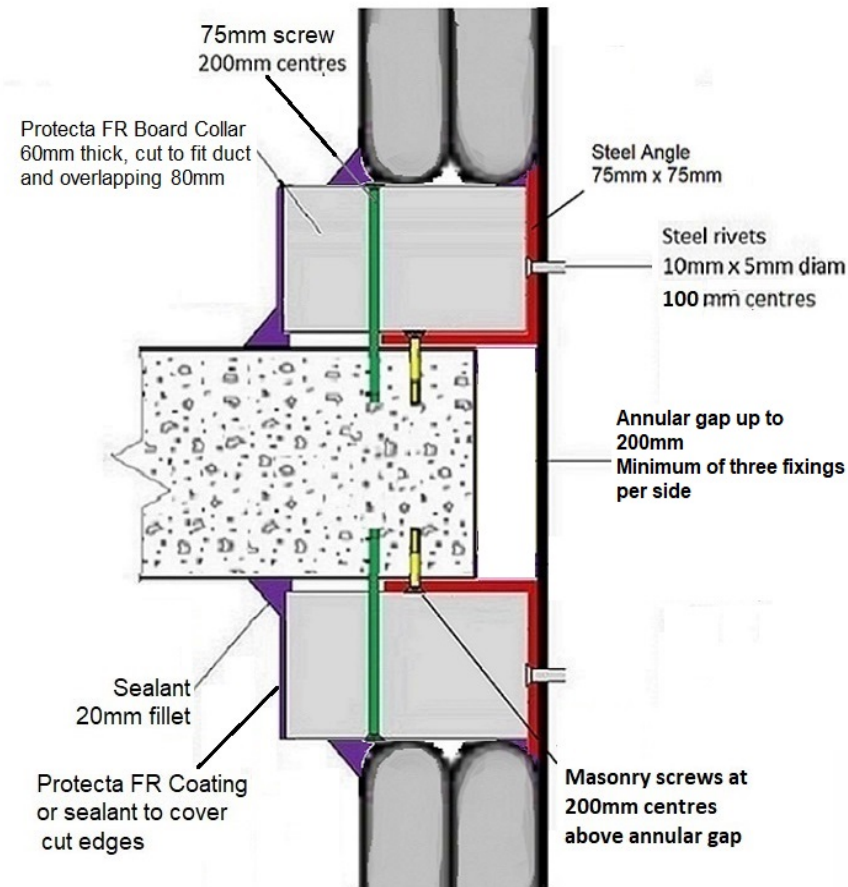

FIRESTOP Duct Wrap-38 Circular Duct (up to 1000mm diam) in a rectangular aperture Concrete Floor (100mm thick or greater) Internal or External Fire

FireTS Lab

Report FTSL AR23108, Pages 22-29
AS1530.4-2014 AS4072.1-2005

System ID# FC71

Products	FIRESTOP Duct Wrap-38 Protecta FR Board Sealant (FR Acrylic or Ultra)
Application	Fire stopping of circular duct penetrating a concrete floor
Construction	Concrete floor min 100mm thick

Fire Classification

NOTE: For general instructions on installing FIRESTOP Duct Wrap-38 see [Installation Instructions](#) sheet on Firestop Centre website.

FRR 60/60/-

Below floor single layer wrap
Above floor single layer wrap

FRR 60/60/30

Below floor single layer wrap
Above floor single layer with 1600mm second
layer

FRR 120/120/90

Below floor double layer wrap
Above floor single layer wrap with 2100mm
second layer

Where FRR of the floor is less than the above ratings, the FRR of the penetration is reduced to match the floor.



FIRESTOP

Firestop Centre Ltd
657 Great South Road
Penrose, AUCKLAND

As a part of our policy of on-going product development and testing, we reserve the right to modify, alter or change product specifications without giving notice. All information contained in this document is given in good faith and is provided for guidance only. Any drawings provided are for illustrative purposes only. As Firestop Centre has no control over the methods or competence of installation and of prevailing site conditions, no warranties, expressed or implied are intended to be given as to the actual performance of the product mentioned or referred to herein and no liability whatsoever will be accepted for any loss, damage or injury arising from the use of the information given.

For all technical details on the products specified please refer to the technical data sheets that can be found on www.firestopcentre.co.nz

Signed and approved:

Sheet size:
A4

Drawn date & no:
20/5/24